

THE INFINITE CORRIDOR

Penn Design: Research Studio
Spring 2015

Professor Marion Weiss

Visiting Critic: Michael Manfredi

TA: Eric Bellin

Meyerson Hall

Monday / Wednesday / Selected Friday

THE INFINITE CORRIDOR IN THE ACADEMY



THE INFINITE CORRIDOR IN THE WORK PLACE



THE LARKIN BUILDING, 1904

THE INFINITE CORRIDOR IN THE CITY

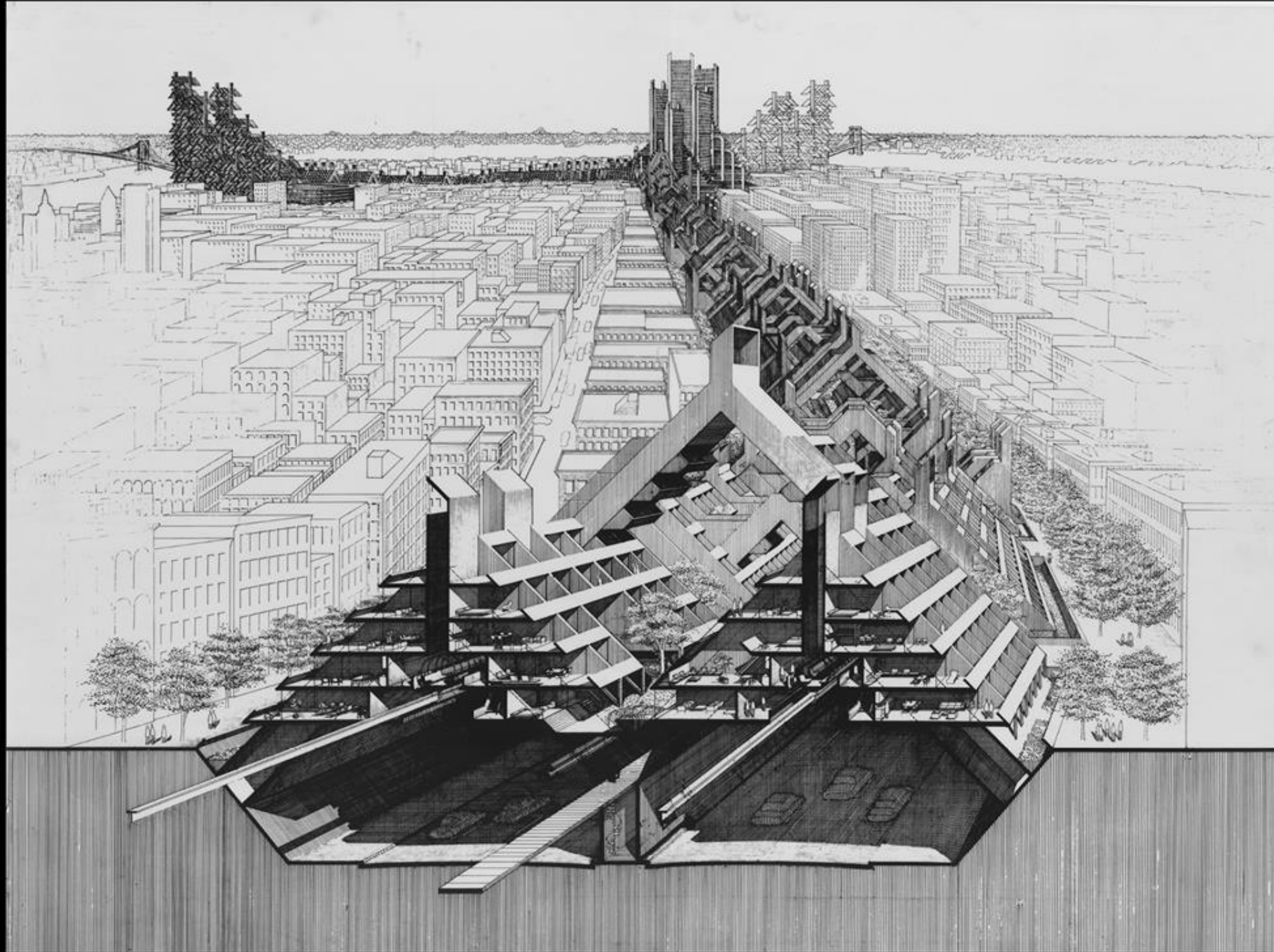

LOWER MANHATTAN EXPRESSWAY, PAUL RUDOLPH, 1967

THE INFINITE CORRIDOR IN THE CITY

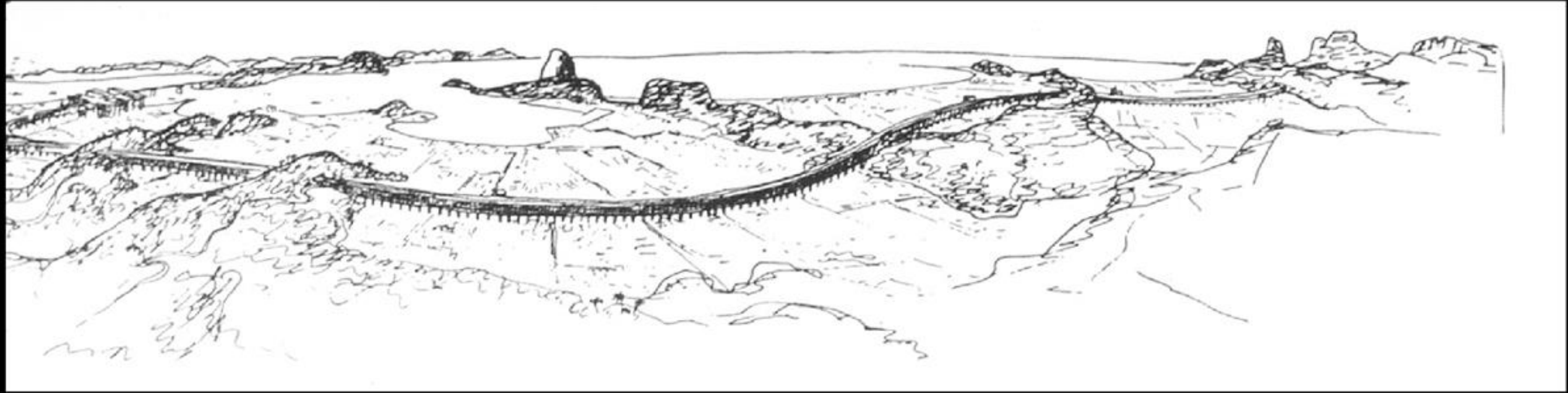

PROJECT FOR ROAD BUILDING, RIO DE JANEIRO - 1929

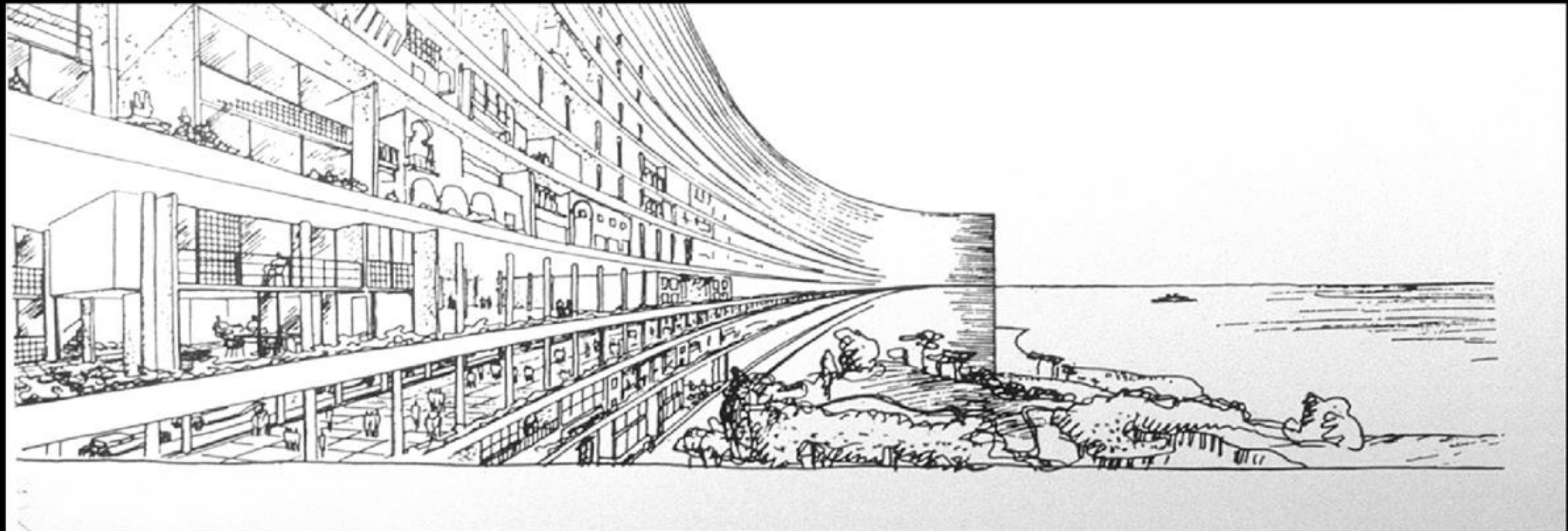

PLAN OBUS FOR ALGIERS, LE CORBUSIER - 1930-34

THE INFINITE CORRIDOR IN THE CITY

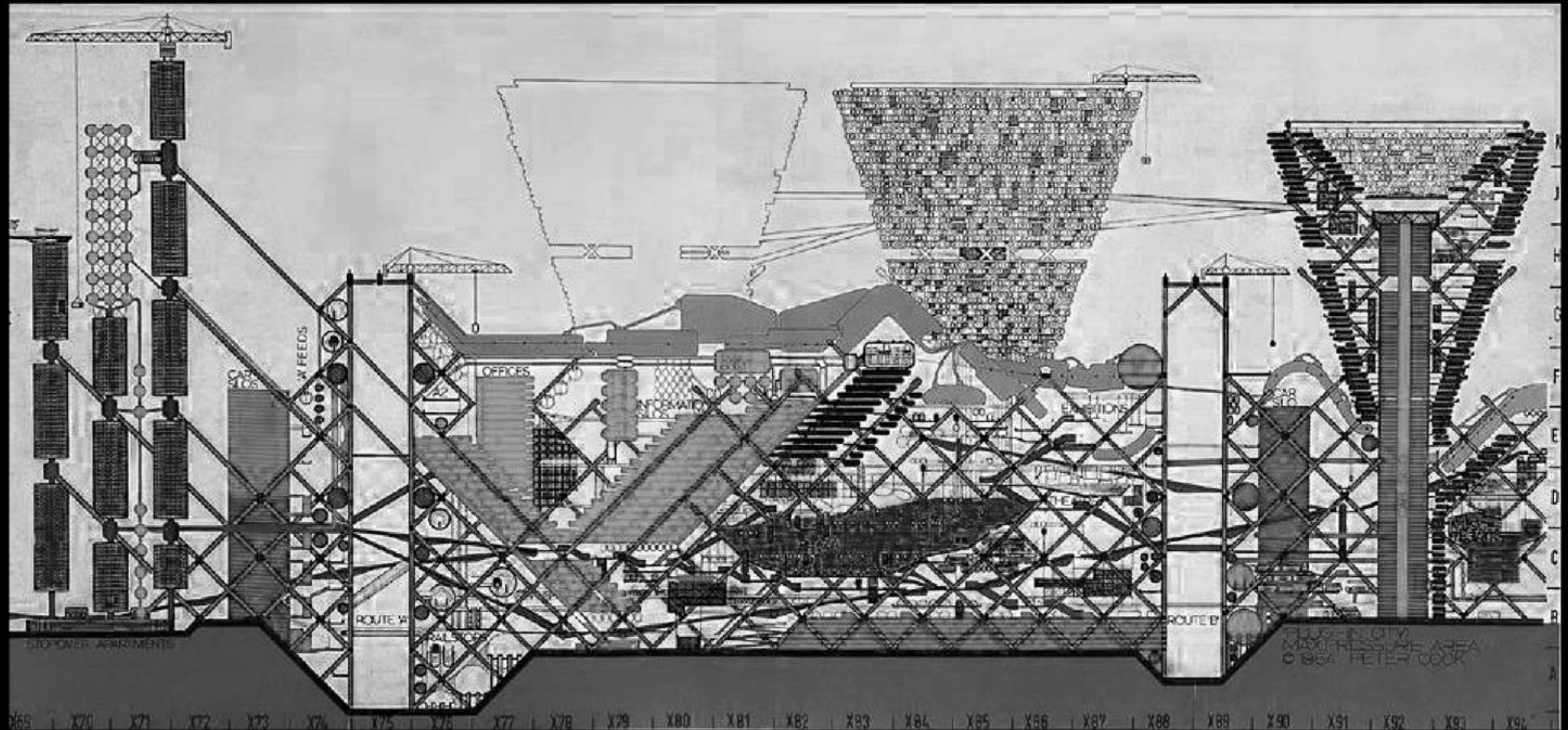

PLUG-IN-CITY, PETER COOK, ARCHIGRAM - 1964

CONSTRUCTING THE LATERAL URBAN TERRAIN



GIANT INTERACTIVE'S HEADQUARTERS, SHANGHAI, MORPHOSIS, 2011

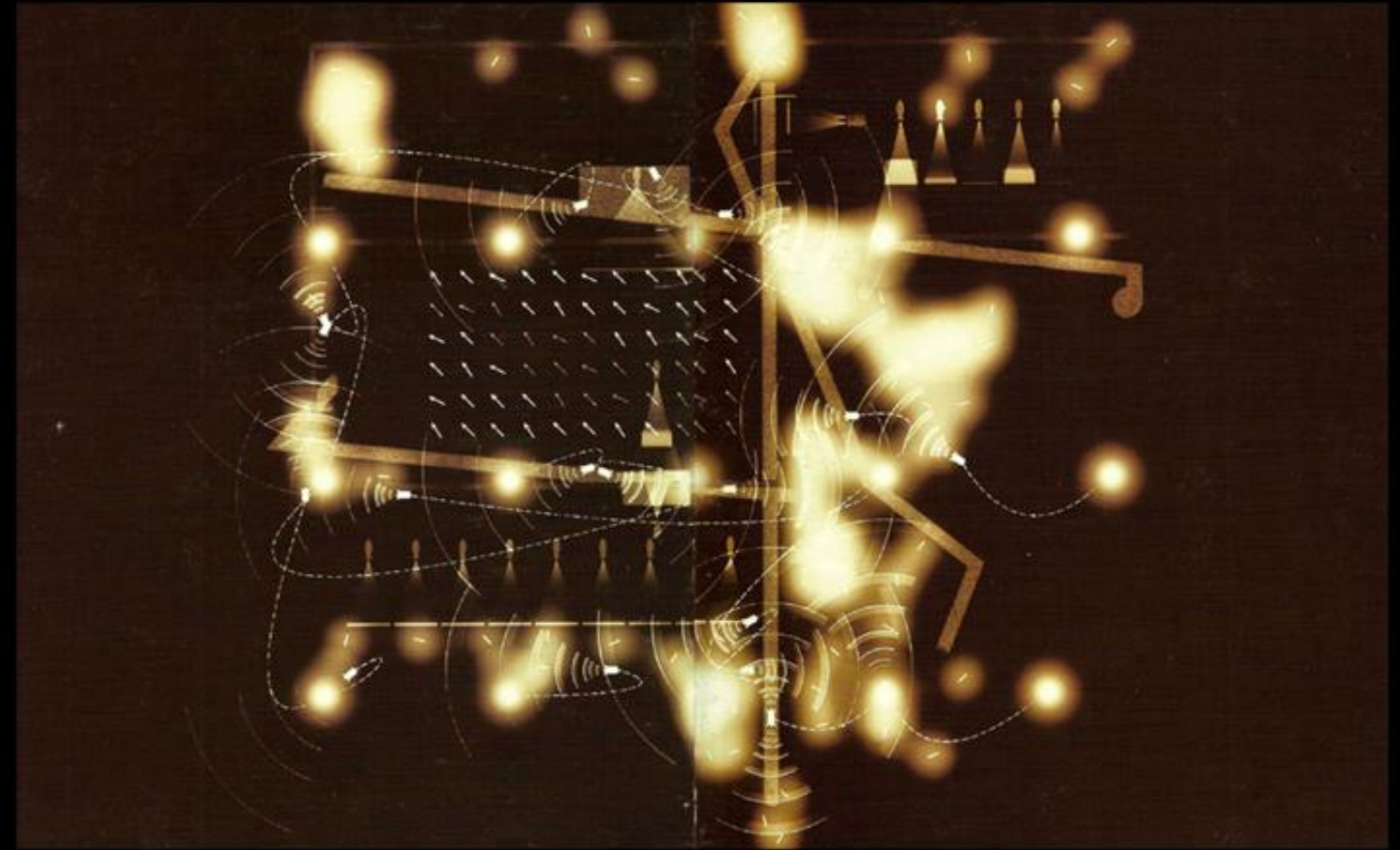

LE FRESNOY ART CENTER TOURCOING, BERNARD TSCHUMI , 1997

CONSTRUCTING AN ELEVATED URBAN TERRAIN

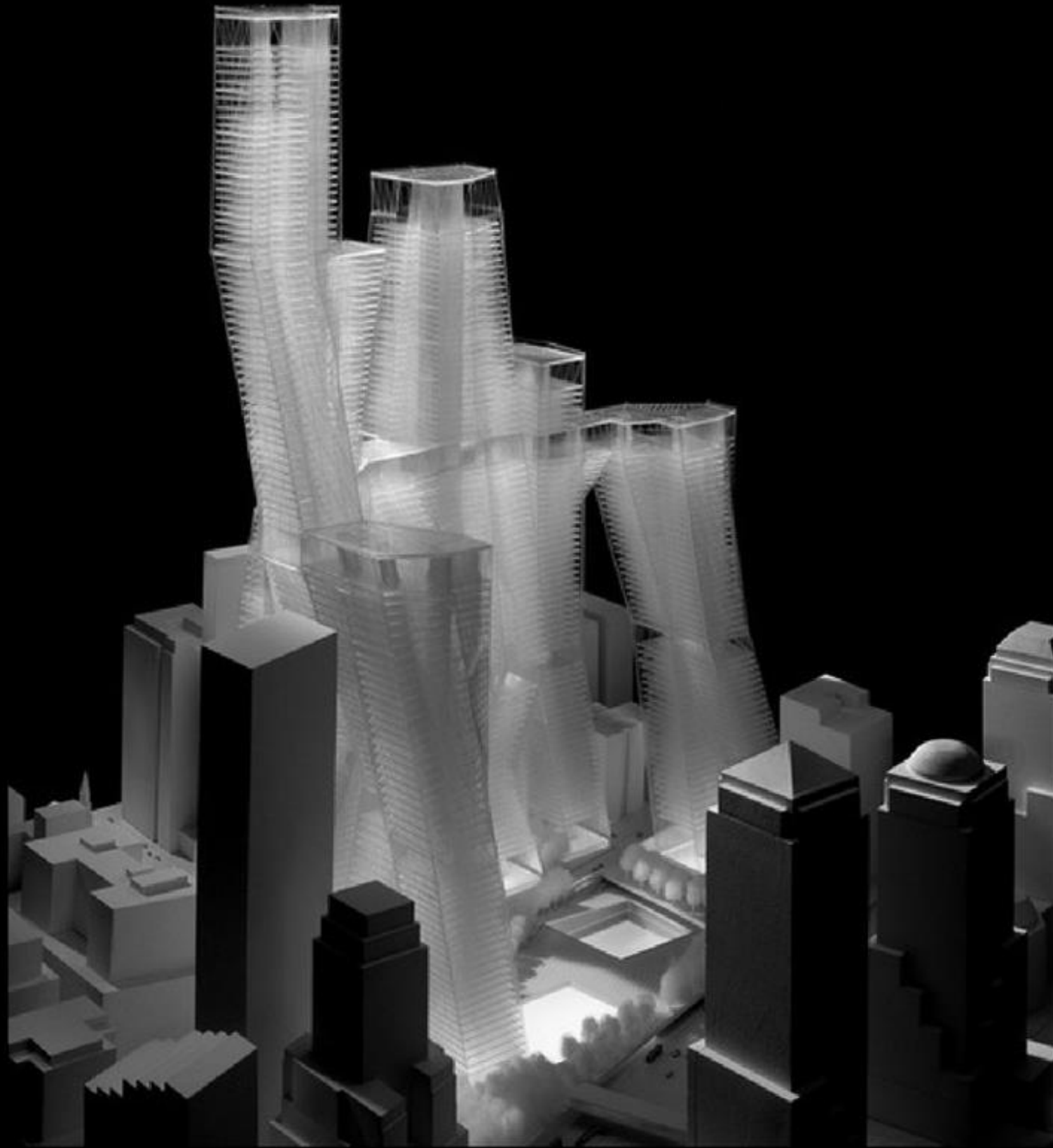

WORLD TRADE CENTER, UNITED ARCHITECTS, 2003



LINKED HYBRID, STEVEN HOLL, 2009



SKIN

- glass curtain wall
- metal panel

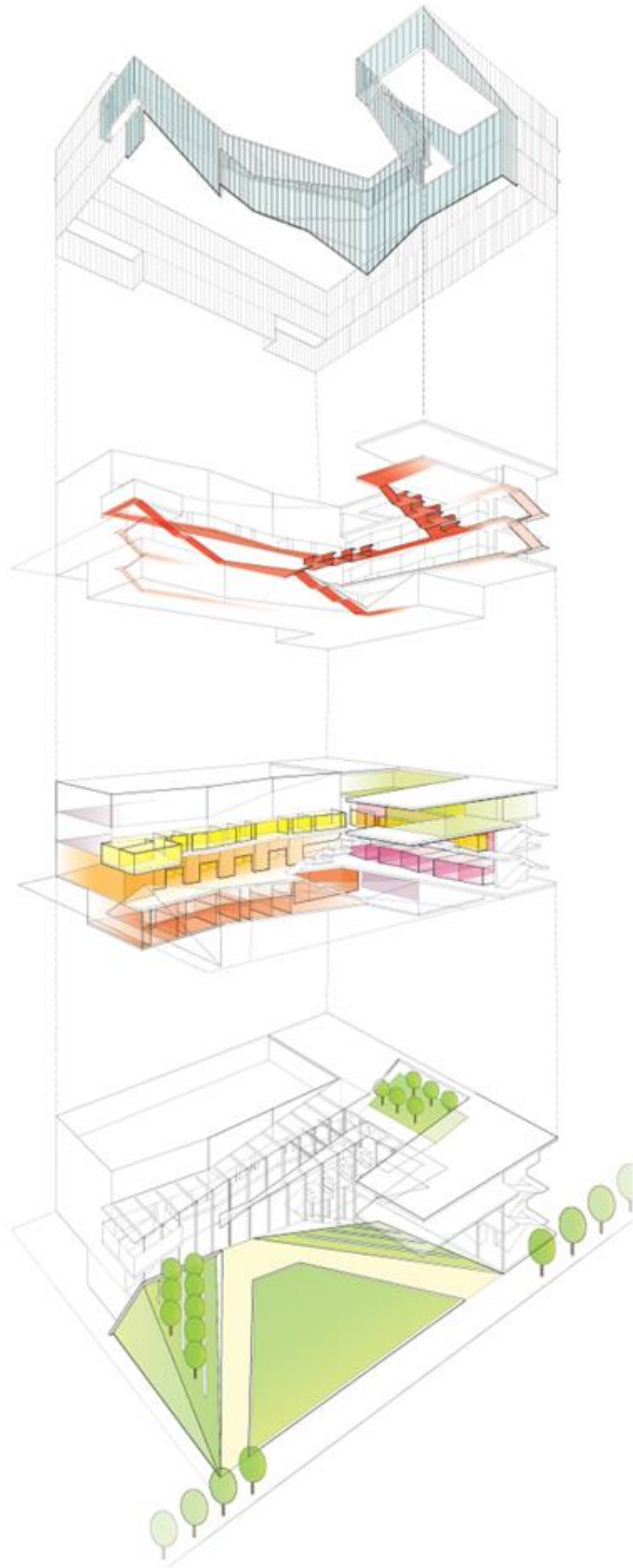

CIRCULATION

- primary route
- secondary route

RESEARCH & COLLABORATION

- torum space
- offices
- cleanroom
- characterization
- general laboratories
- MEP

LANDSCAPE

- green roof
- campus landscape



ACID ETCHED GLAZING PATTERN

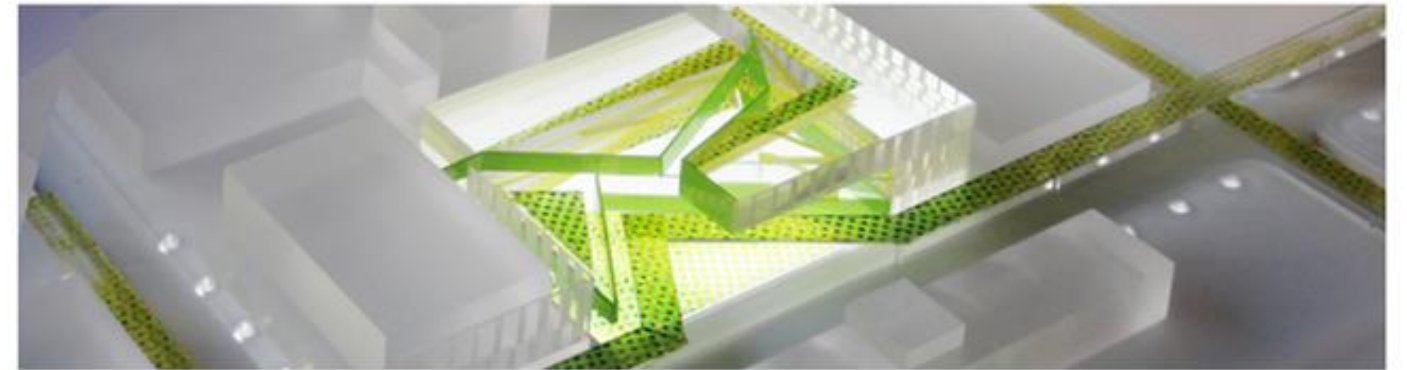

MOVEMENT



AMBER FILTERED LIGHT: CLEANROOM



CAMPUS CROSSROADS











MIT + KENDALL SQUARE
THE ACADEMY + THE ENTREPRENEUR







A REMARKABLE BUILDING TRADITION



KRESGE AUDITORIUM AND CHAPEL, EERO SAARINEN, 1955



CHAPEL, EERO SAARINEN, 1955



BAKER HOUSE, ALVAR AALTO, 1948

A PLACE OF INNOVATION, CHANGE, AND INTERACTION

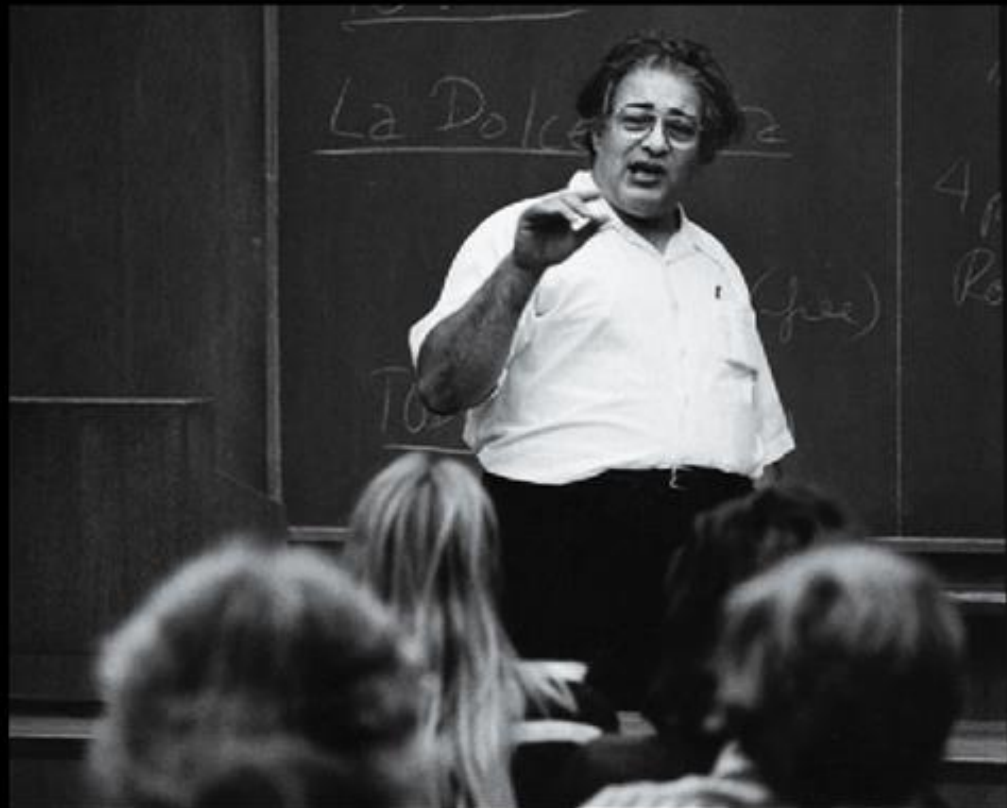

**"BUILDING 20 WAS THE NEST IN WHICH NEW NOTIONS COULD BE FLEDGED."
- PROFESSOR EMERITUS JEROME Y. LETTVIN**

THE INFINITE CORRIDOR, 1943-1945



PEDESTRIANS COMPETE FOR SPACE WITH A MICROWAVE DISH ON A CART
IN BUILDING 20'S BUSY CORRIDOR DURING RAD LAB DAYS.

A NEW PARADIGM: RESEARCH, LEARNING, AND INNOVATION





**Directed Research
Delayed
Application**

**Start-Up Model
Accelerated
Research/Production**

THE ACADEMY + THE CITY



MIT + KENDALL SQUARE

KENDALL SQUARE: A NEIGHBORHOOD OF INNOVATION

NUMBER OF BIOTECH + IT FIRMS PER SQUARE MILE: KENDALL SQUARE 163 VS PALO ALTO 36



YAHOO



NOVARTIS



GOOGLE



APPLE



AMAZON



MICROSOFT

DEVELOPMENT OF KENDALL SQUARE

- | | |
|------------------|---|
| 1912 | OPENING OF FIRST SUBWAY LINE |
| 1912-1960 | INDUSTRIAL LANDSCAPE
PRINTING PRESS INVENTIONS |
| 1916 | MIT MOVES FROM BOSTON BACK BAY TO CAMBRIDGE |
| 1943 | BUILDING 20 |
| 1955 | CAMBRIDGE REDEVELOPMENT AUTHORITY |
| 1960-2000 | URBAN RENEWAL : OFFICE PARK DISTRICT |
| 1961-1970 | NASA'S ELECTRONICS RESEARCH CENTER |
| 2001 | CAMBRIDGE CITYWIDE REZONING |

KENDALL SQ. WITH FILLED LAND ALONG MEMORIAL DRIVE, 1910

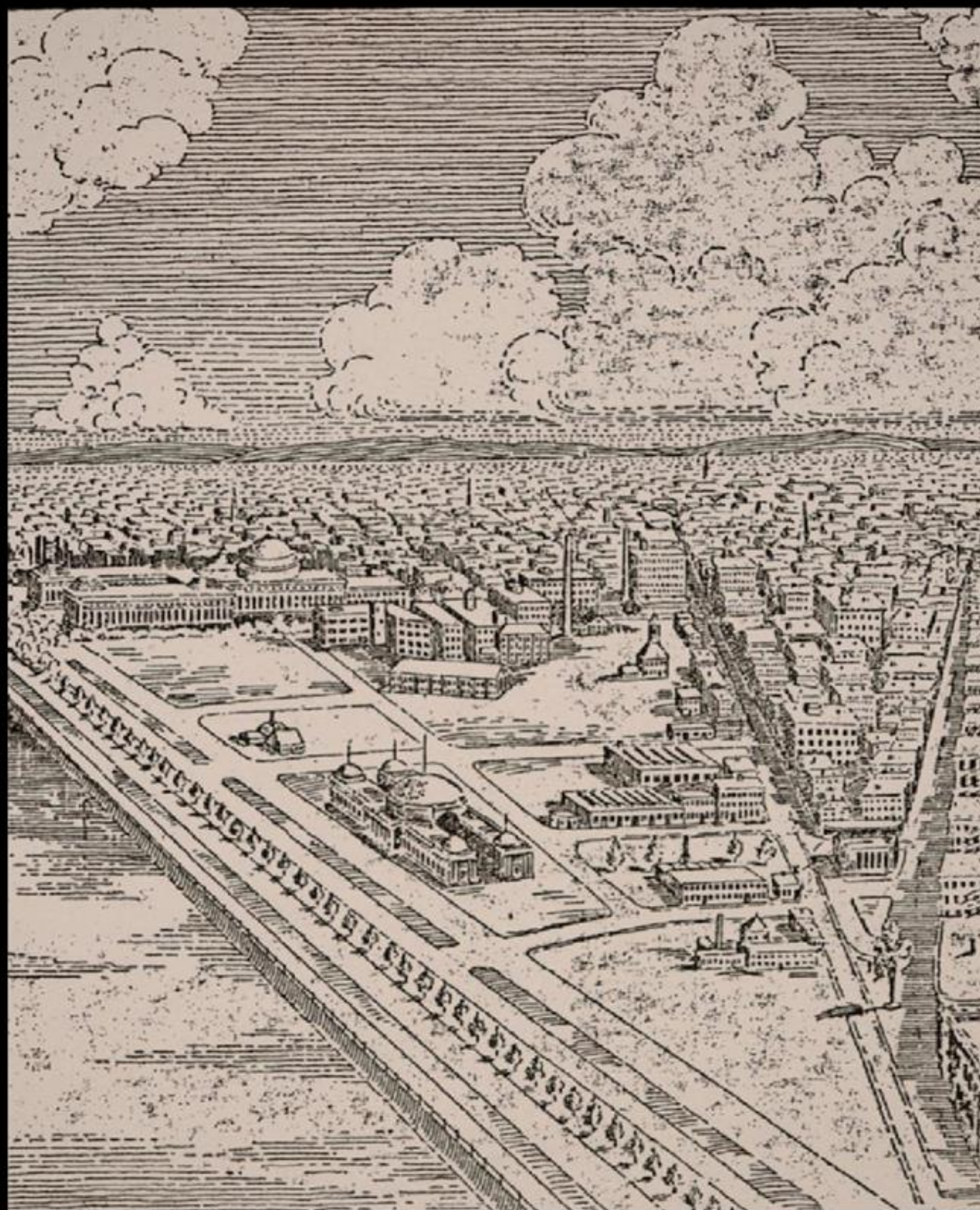

KENDALL SQUARE: INDUSTRIAL HISTORY



KENDALL SQ BUILDING, 1917-1925



MANUFACTURERS NATIONAL BANK, 1917



SUFFOLK ENGRAVING CO., 1920

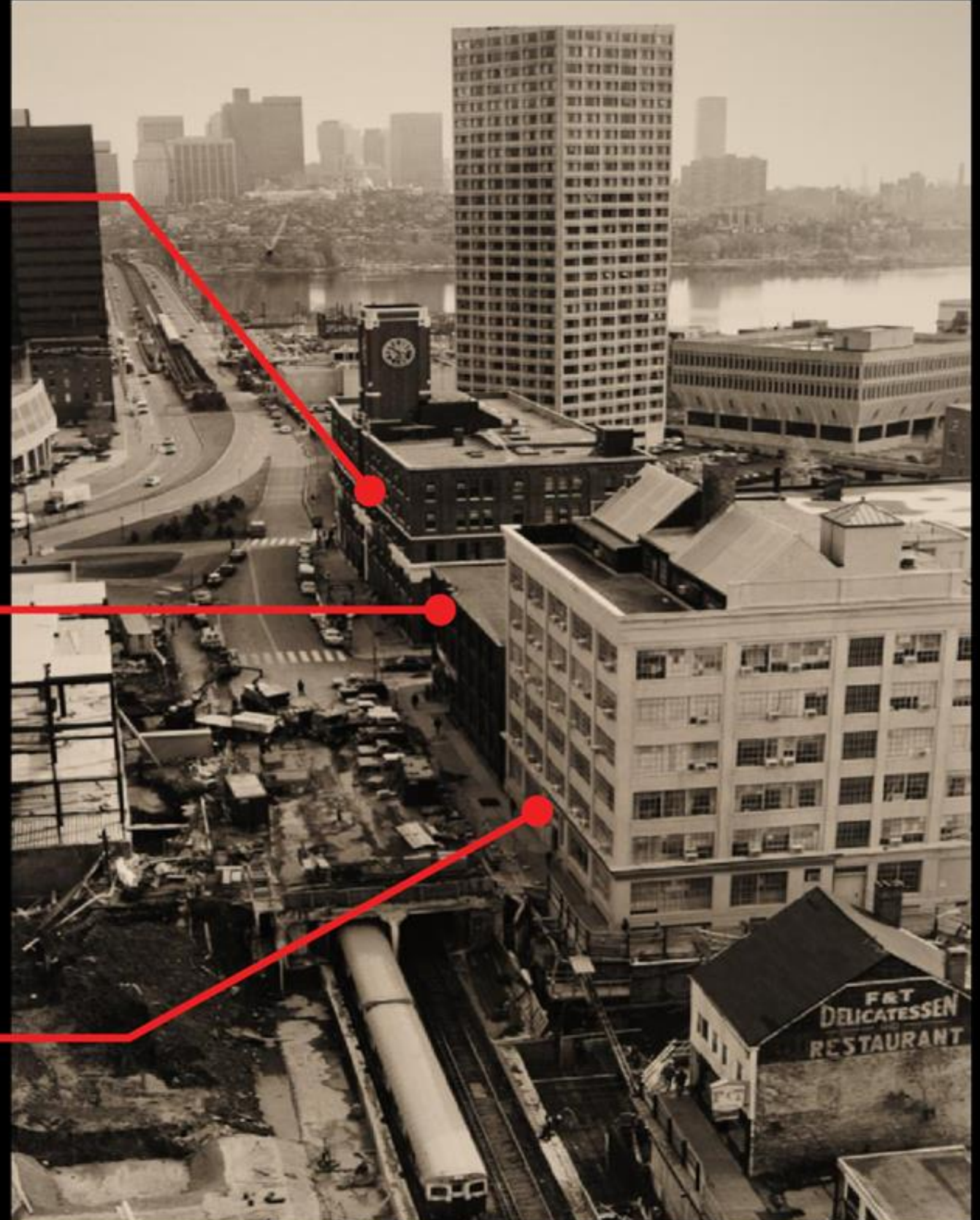

PROPOSED NASA SPACE CENTER, 1961

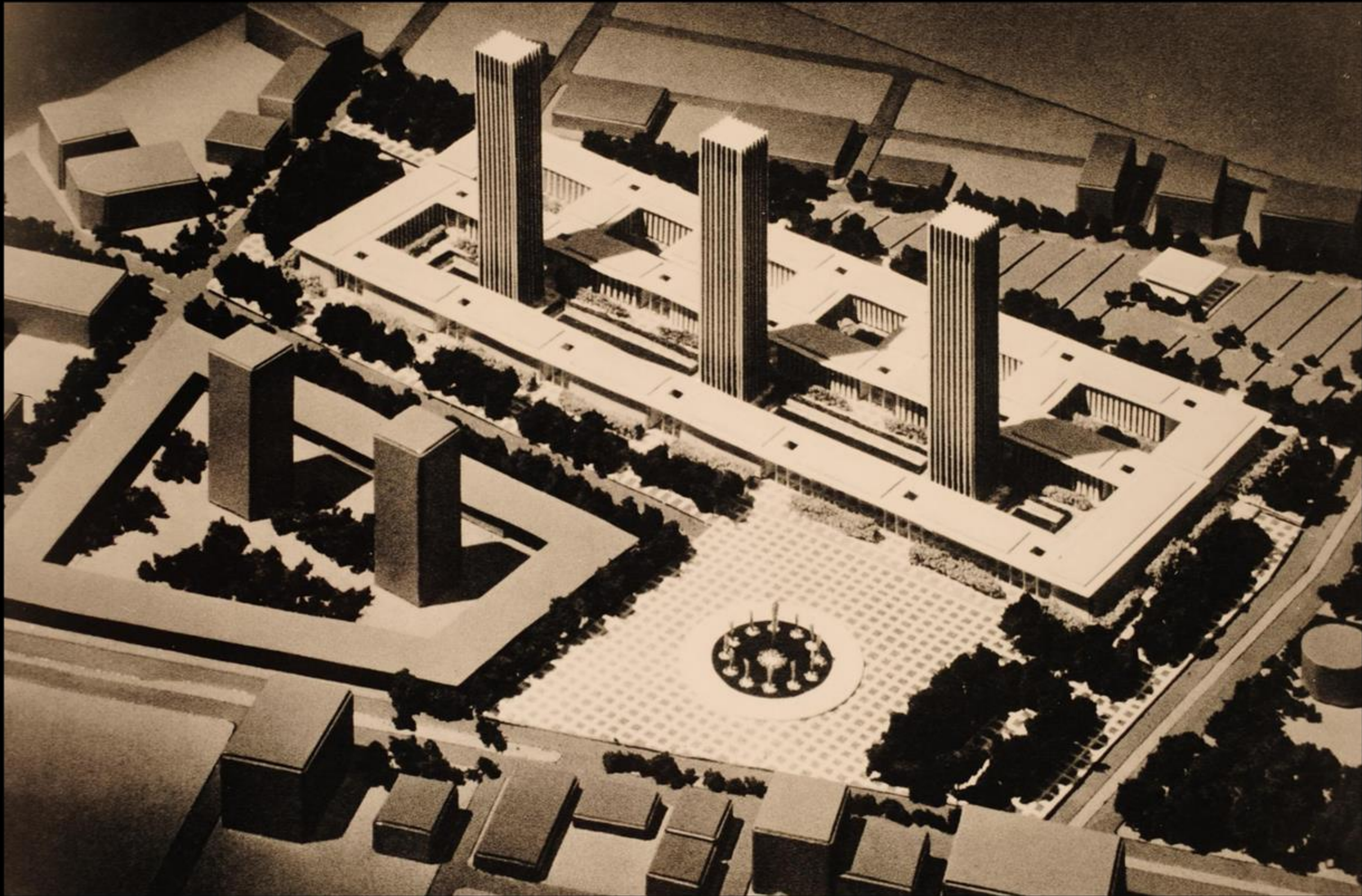

NATIONAL GOVERNMENTS PRIORITIES SHIFTED, THE PLAN TO LOCATE NASA AT KENDALL SQUARE WAS CANCELED, 29 ACRES OF LAND LEFT EMPTY

PROPOSED NASA SPACE CENTER, 1961: CANCELED IN 1970



MODEL OF PHASE I. (FROM LEFT) DR. ALBERT J. KELLEY, DEPUTY DIRECTOR; EDWARD DURELL STONE, ARCHITECT; DR. WINSTON E. KOCK, DIRECTOR

KENDALL SQUARE, 1964



KENDALL STATION EXPANSION, 1985





MIT Campus 2013



SITE LOCATIONS AND USES

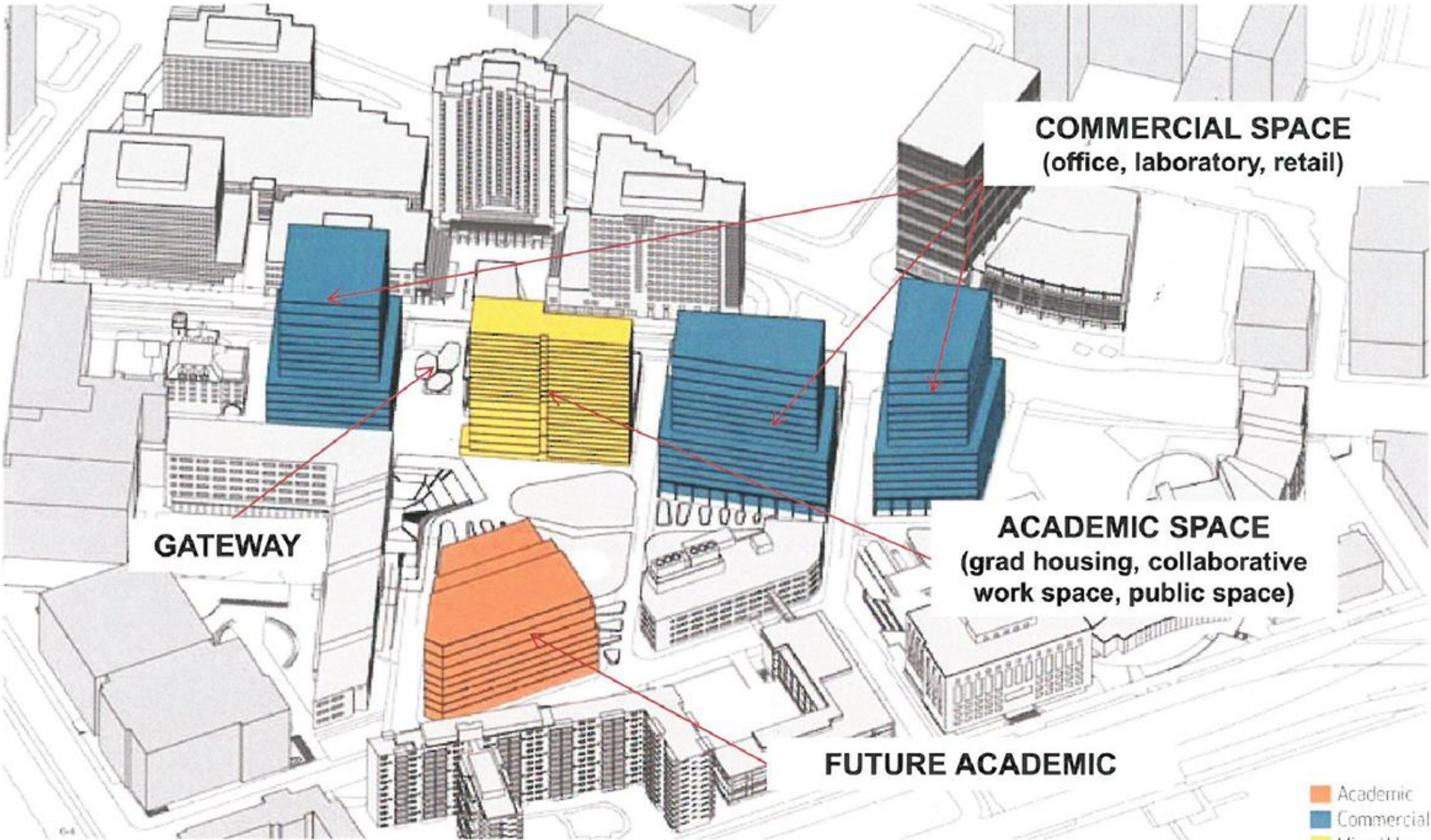



EXTENDING THE INFINITE CORRIDOR



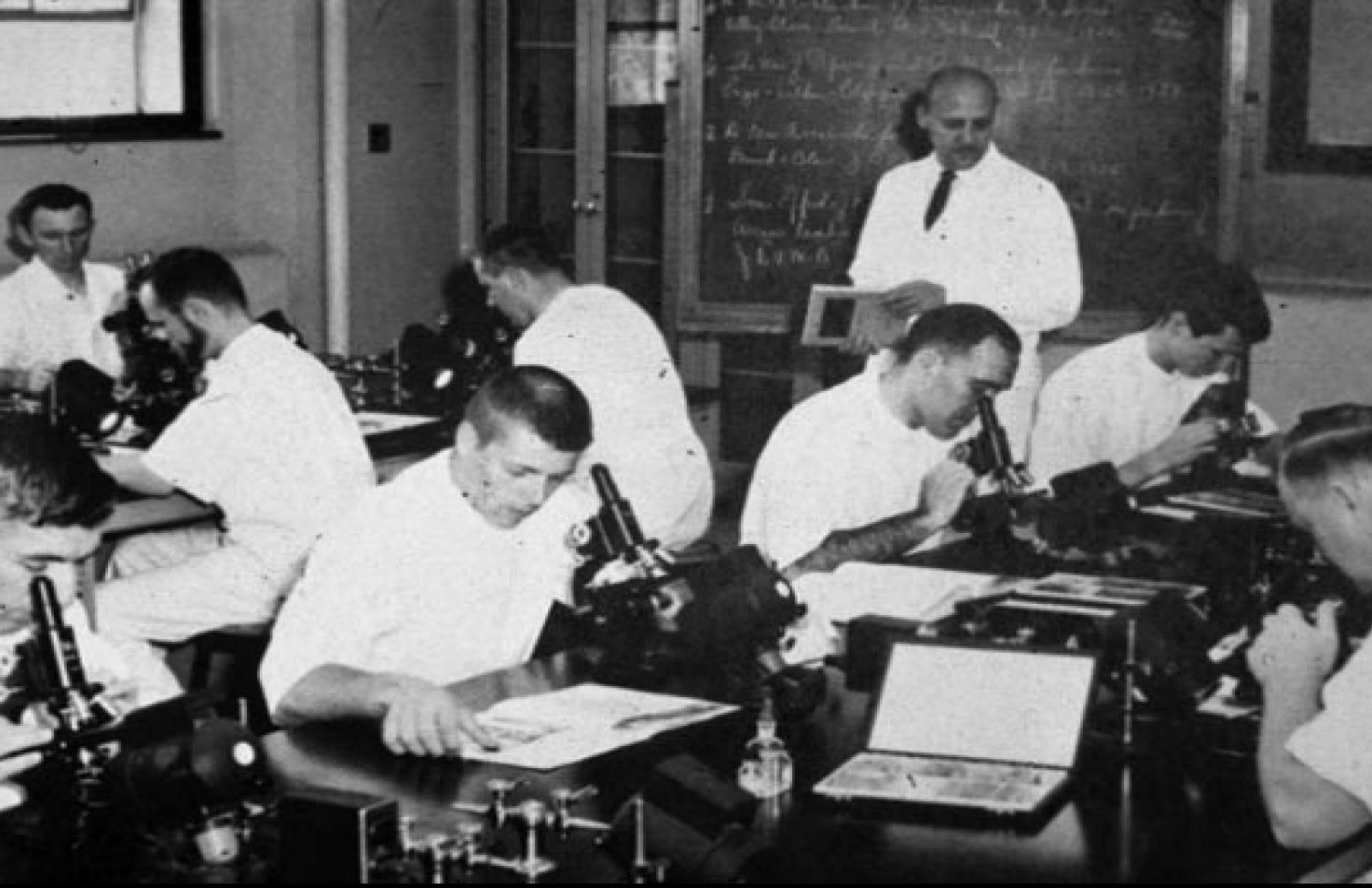

A NEW LENS ON THE CITY



A FUTURE DESTINATION

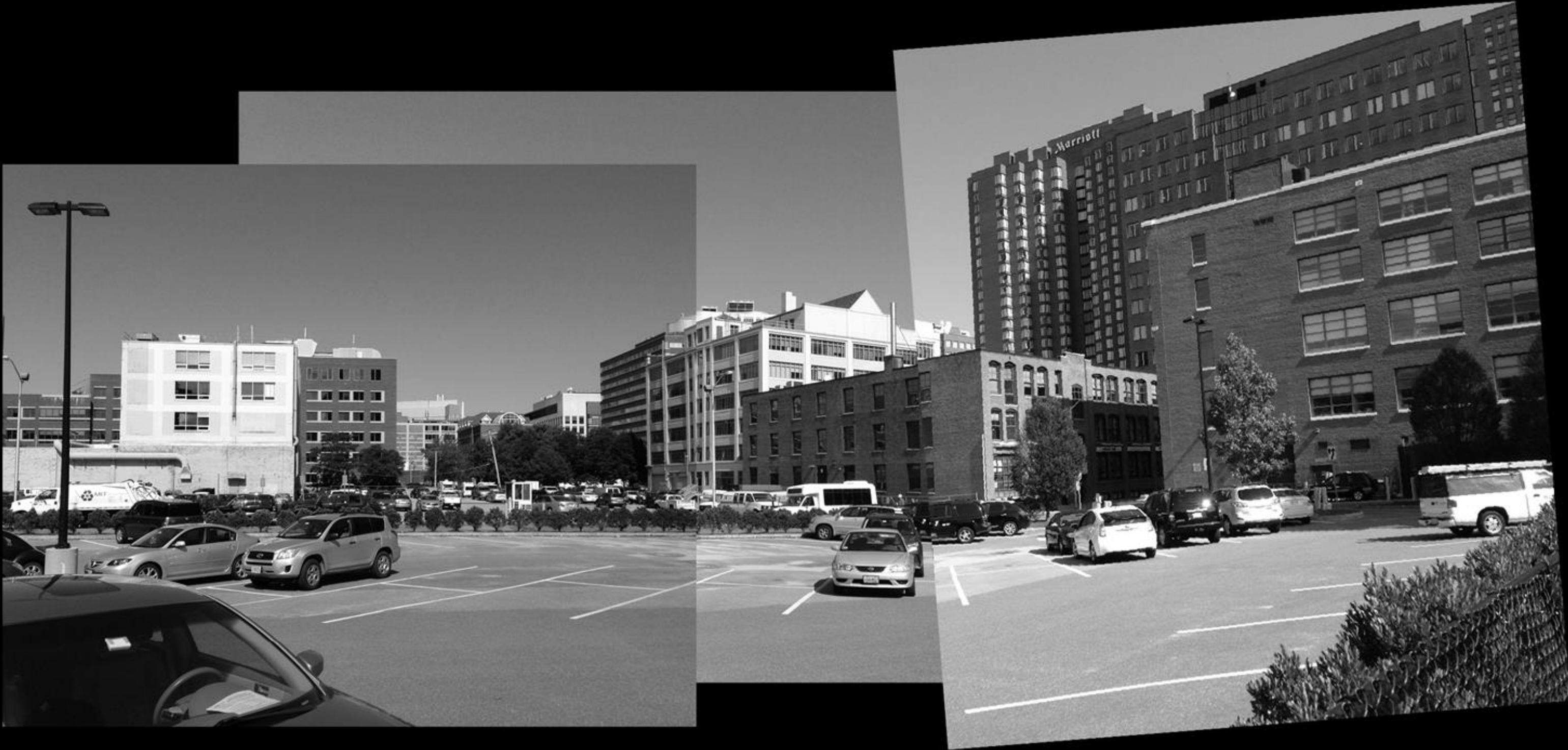

A CAMPUS GATEWAY



