



# **XEROX 7800 PRINTING Adobe ILLUSTRATOR (PHASER)**

## **General Lab Information**

-Please, no food in the labs.

-You are not permitted to use the lab when a class is in session, unless you are in the class.

-ADDM\_Matte (HP Z6200 Printer) has HP Super Heavy Weight Coated Matte paper and costs \$1 per square foot.

-ADDM\_Satin (HP Z6200 Printer) has HP Instant Dry Satin paper and costs \$1 per square foot.

-PHASER (Xerox 7800 Printer) has both card stock and standard paper options  
8.5" x 11" - .15 single sided, .30 double sided  
11" x 17" - .30 single sided, .60 double sided

-Always work/print from the desktop

-Convert your file to RGB color mode when sending your file to a ink jet printer

-Convert your file to CMYK color mode when sending your file to a laser jet printer

-Flatten your working file, rename it and save to your desktop. This will generate a new file for print. Be sure to save your working file with adjustment layers onto your external drive.

-Both printers use specific ICC color profiles for the specific paper loaded in each printer.

-Allowing the printer to manage color will give you the most accurate result.

-If you print on the wrong media you will still be charged for the job.

-If you do send your job to the wrong printer, make sure to remove the old job ASAP!

-If your job is larger than 400MB, it may be deleted from the printer queue. If you are sending a large file, let the IT staff or the lab assistant know it was intentional. Note: If you format your file correctly, and apply the principles you learn in your classes, then 50MB limit will not be an issue.

-Be courteous when getting your job; do not damage other peoples' work to get to you own.

-Clean up after yourself; that means, if you cut your print down, put the scraps in the Recycling bin (the one labeled for paper).

# XEROX 7800 GX Specs.

Cut-sheet size - 5.8" x 8.3" up to 11" x 17"

## Illustrator PREP (COLOR)

*Laserjet Printing with a Color-Managed Workflow*

Open your file in Illustrator if you haven't already.

1. Set correct Color Profile
  - a. Make sure your file is set to Working CMYK-US Web Coated (Swop) V2. First, set the Document Color Mode to CMYK Color (File > Document Color Mode > CMYK Color). Then open the Assign Profile window (Edit > Assign Profile...). Under "Profile:," select Working CMYK-US Web Coated (Swop) V2.

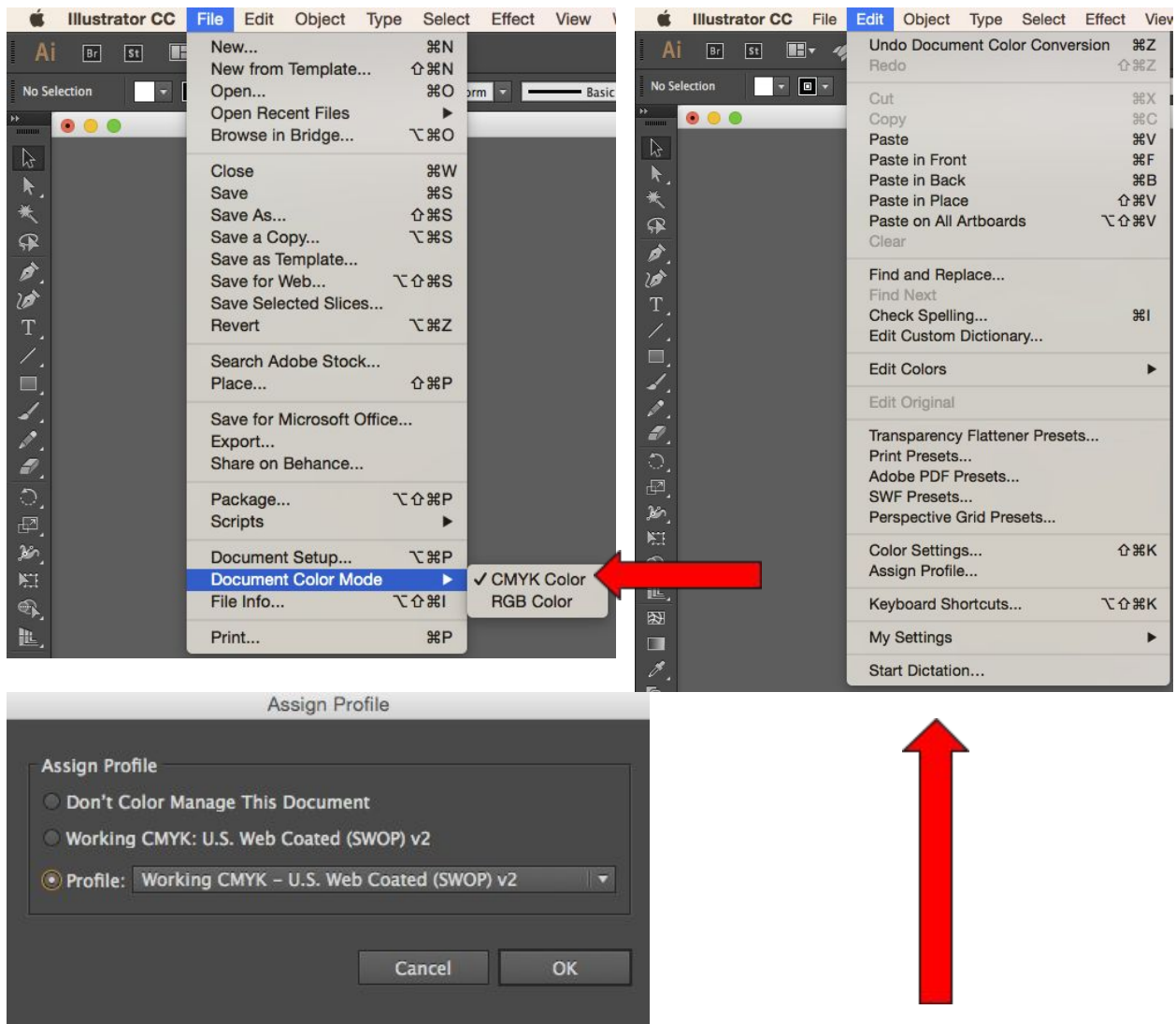

2. Send it to print!

- a. Your file is now ready to print. Take care to manage the following print settings. Open the Print dialogue box (File > Print).

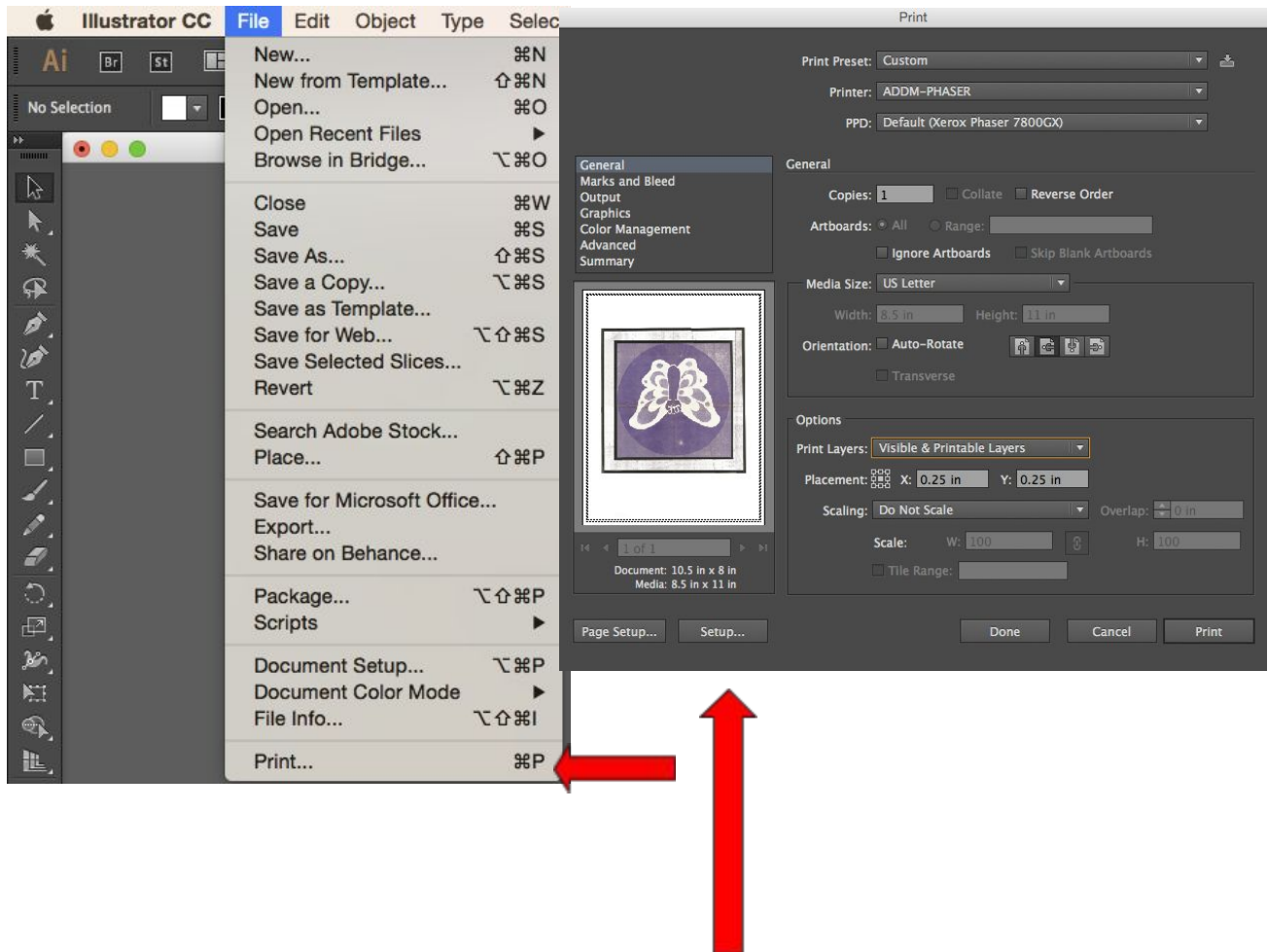

- b. Under “Printer,” select ADDM-PHASER as your printer. Then open the Print Setup dialogue box by selecting “Setup” from the bottom left of the Print dialogue box. Click “Continue” from the pop-up window.

Click the Layout drop down menu in the middle of the Print dialogue box and select Xerox Features

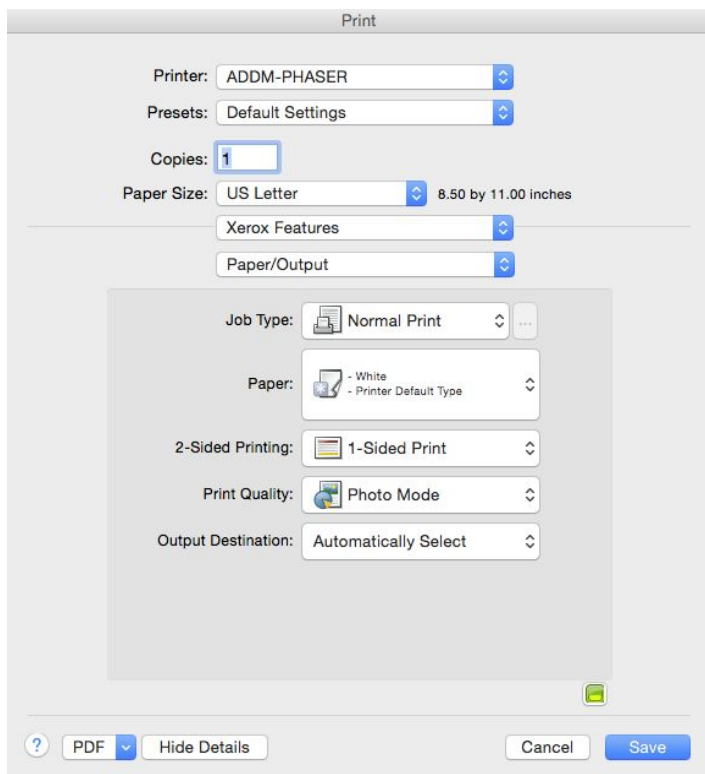
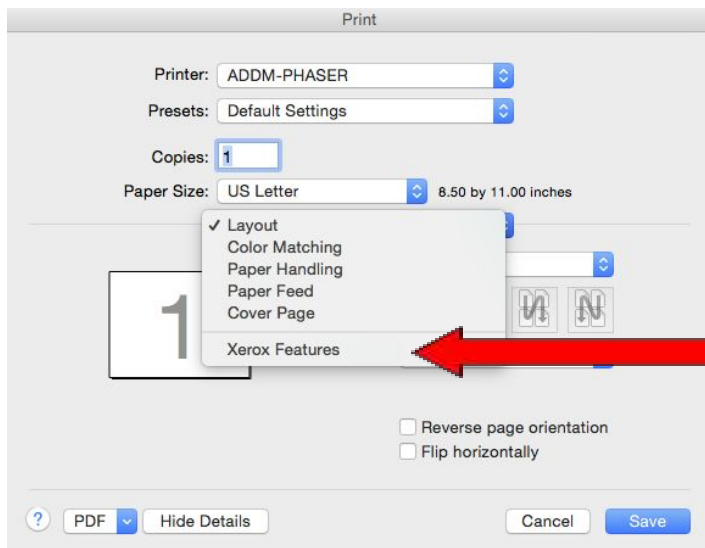

Under Xerox Features, Paper / Output, adjust the following settings:

**Job Type:** Normal Print

**Paper:** Default is set to standard laserjet paper. Choose Cardstock if you're interested in printing on cardstock.

**2-Sided Printing:** Choose 1-Sided Print or 2-Sided Print depending on your file.

**Print Quality:** Choose Enhanced for graphics or Photo Mode for photographs.

**Output Destination:** Automatically Select

If you want to make any color adjustments through the printer driver, click the Paper / Output drop down menu at the top of the Xerox Features dialogue box and select Color Options.

For Color Correction, choose Automatic or Black and White. You can also select Custom Color Options, which will open a new window. Select the Color Adjustment panel for additional color corrections.

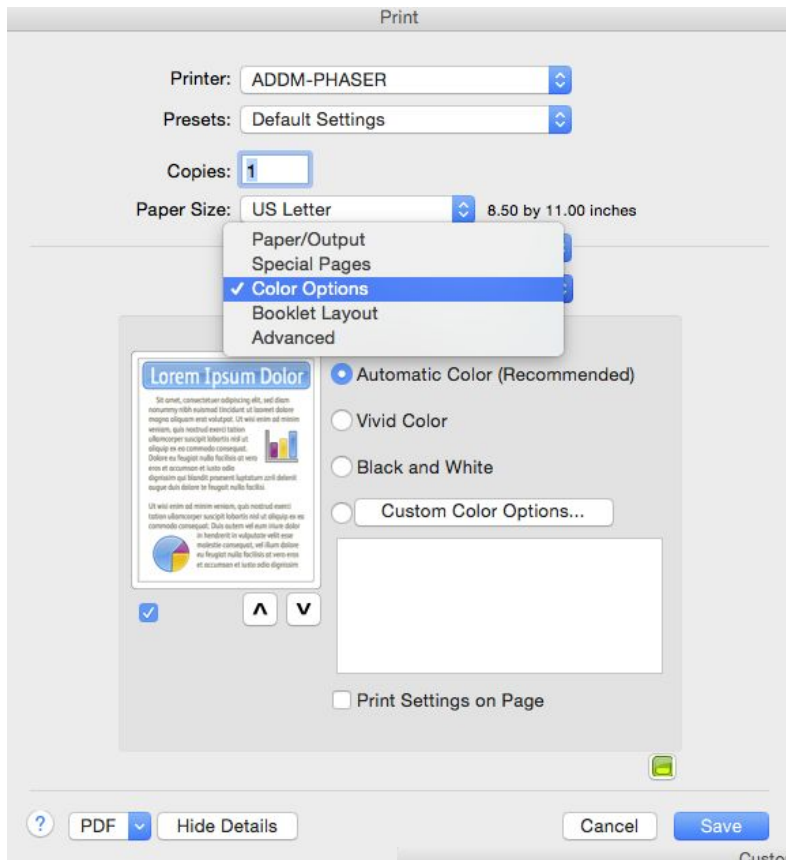

OK

SAVE



Now you can preview your image and manage just a few more settings.

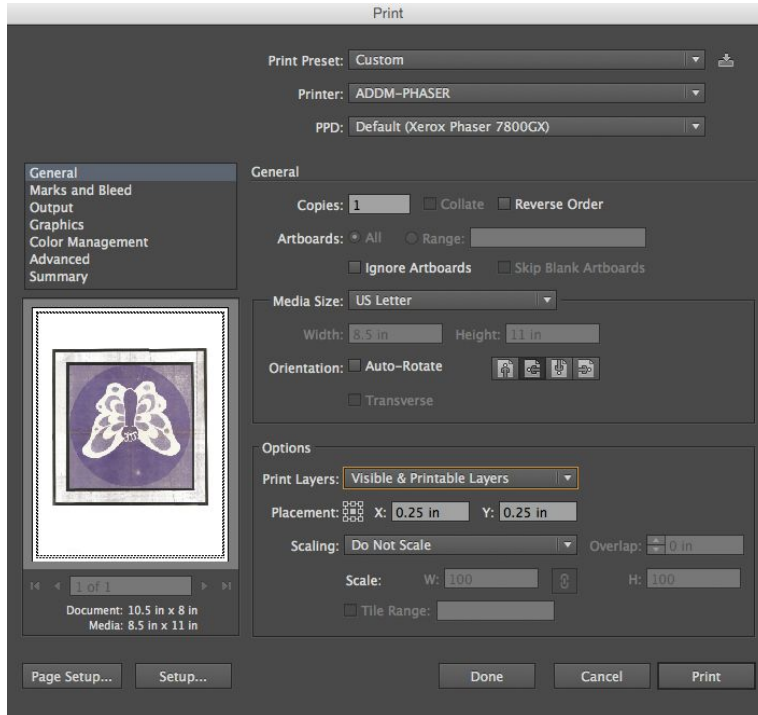

c. After clicking SAVE, you'll be brought back to the Print dialogue box. Under "General," choose how many copies you want. Printing one is suggested before making multiple copies.

d. Select the appropriate Layout for your image, whether it is a portrait or a landscape.

e. Under "Color Management" on the left-hand menu in the Print dialogue box, select the following settings:

**Color Handling:** Let Illustrator determine colors

**Rendering Intent:** Perceptual or Relative Colorimetric, depending on what you chose in soft proofing

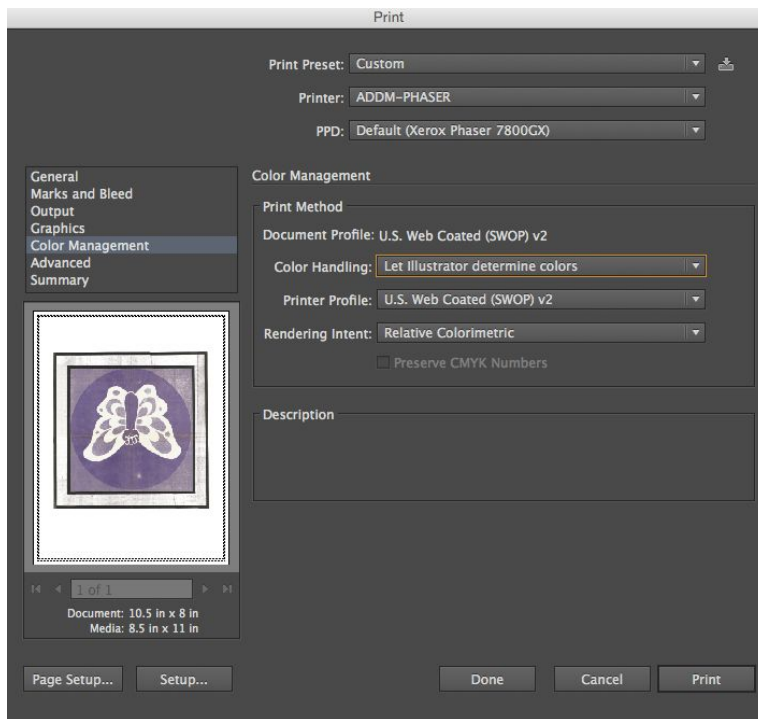

**PRINT**