

KIMMEL CENTER

CONNECT TO THE ARTS

A plan for the Kimmel Center that
invigorates the building with public arts of every stripe,
embraces its majestic size,
and adopts socially-conscious, sustainable operating principles.

Andrew Watterson, Mindy King, Rachel Gogel, and Crista McDonald

the plan

KIMMEL
CENTER
CONNECT TO THE ARTS

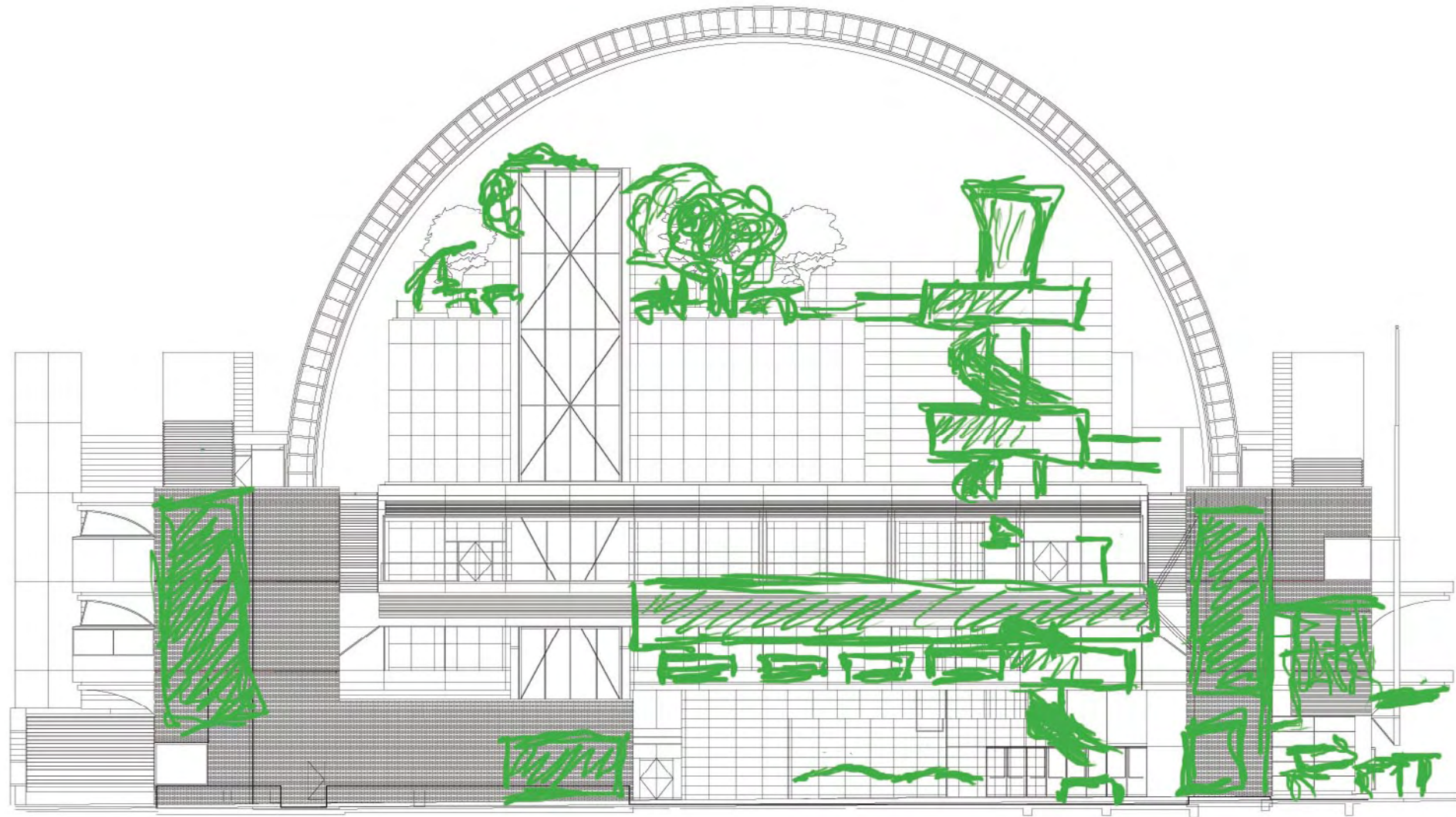

Plaza
Tower

Areas
to Linger

Rooftop
Garden

Café
on Broad

Entrance
on 15th

Information
Display



plaza tower

plaza view, from broad street entrance
existing

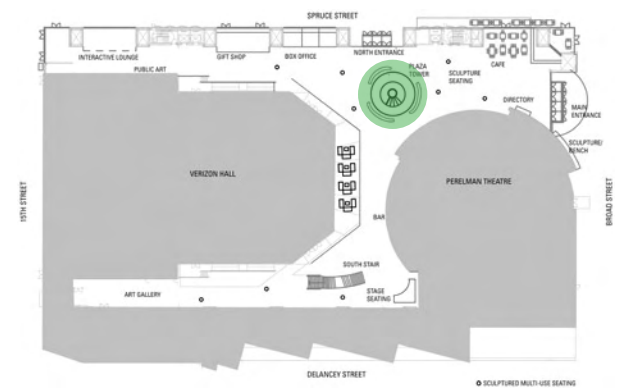

**KIMMEL
CENTER**
CONNECT TO THE ARTS

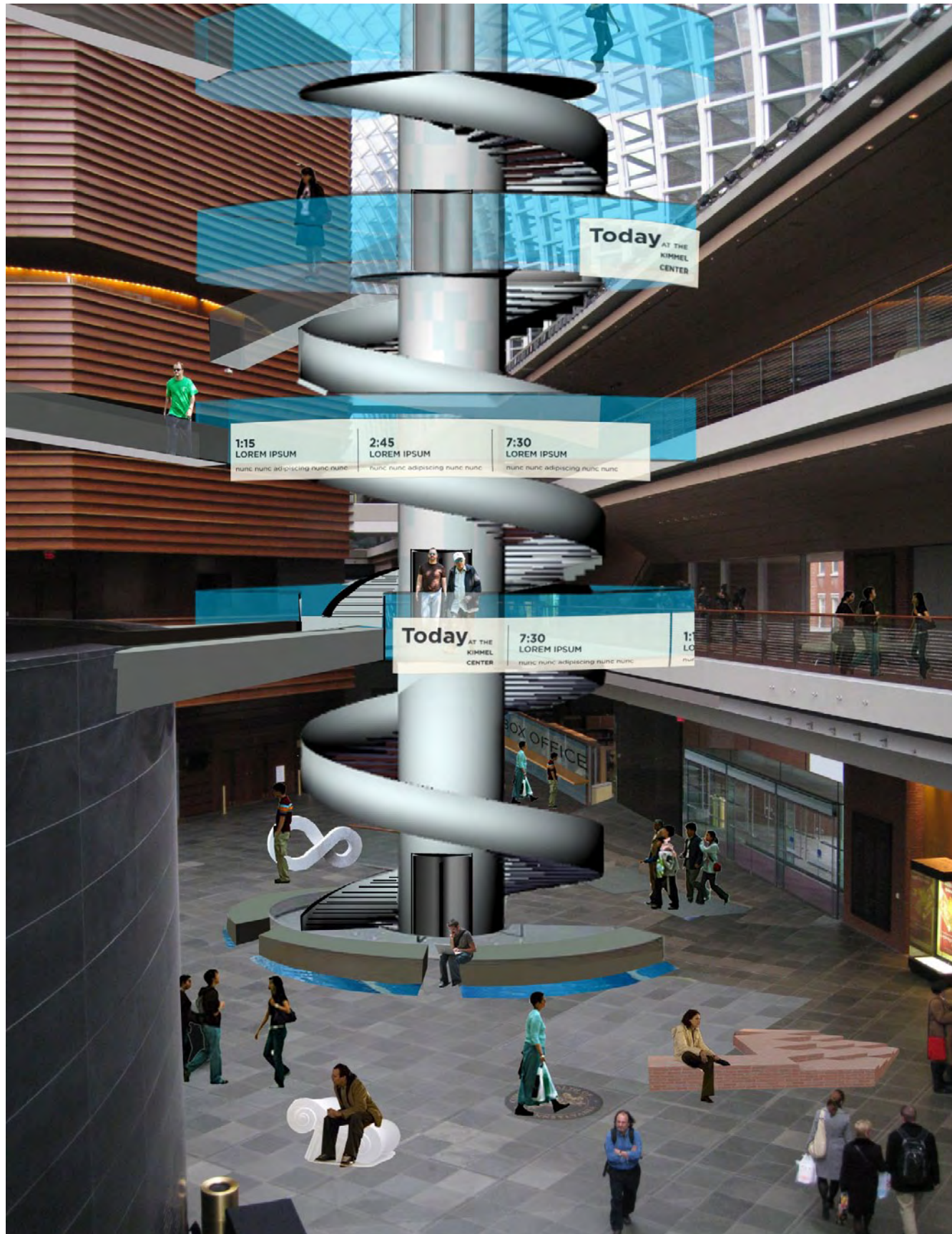

plaza tower

plaza view, from broad street entrance
proposed

key features:

- glass tower
- elevator/staircase
- observation landings
- easy access to tiers and roof garden
- public art as seating

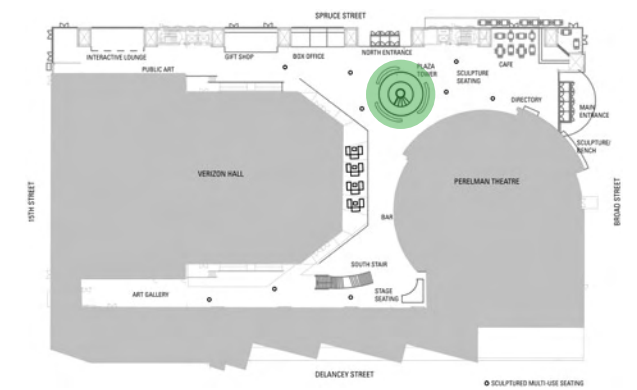

**KIMMEL
CENTER**
CONNECT TO THE ARTS

areas to linger



ground floor, plaza stage area
existing

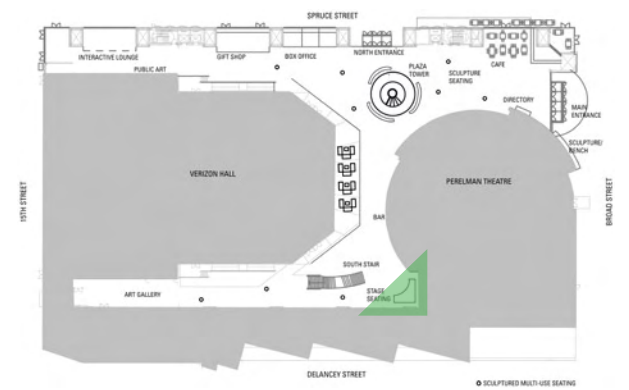

**KIMMEL
CENTER**
CONNECT TO THE ARTS

areas to linger



ground floor, plaza stage area
proposed

key features:

- multi-level stage
- doubles as performance space/seating
- improved lighting
- public art gallery

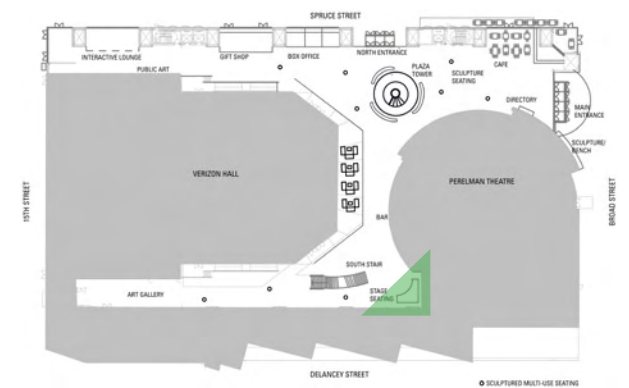

**KIMMEL
CENTER**
CONNECT TO THE ARTS

areas to linger

ground floor, verizon hall overhang
existing

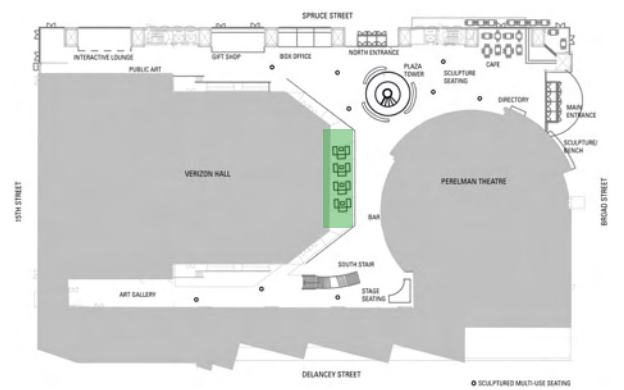

**KIMMEL
CENTER**
CONNECT TO THE ARTS



areas to linger

ground floor, verizon hall overhang
proposed

key features:

- lounge seating
- carpeting
- improved lighting
- public art gallery

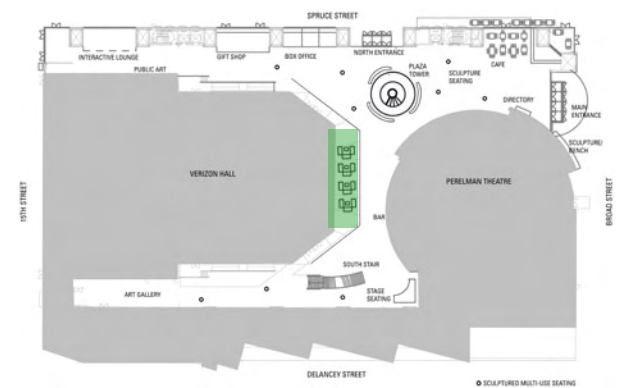

**KIMMEL
CENTER**
CONNECT TO THE ARTS



areas to linger

third tier, carrel space
existing

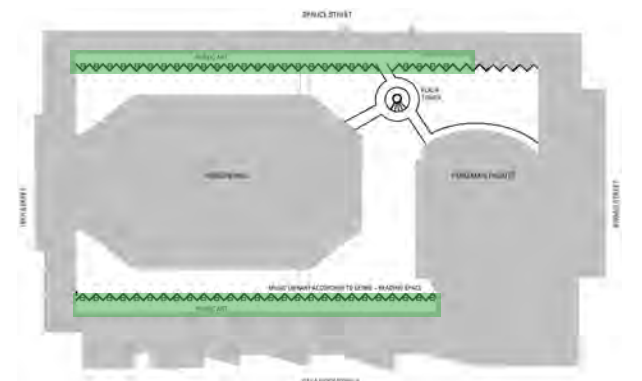

**KIMMEL
CENTER**
CONNECT TO THE ARTS



areas to linger

third tier, carrel space
proposed

key features:

- personal listening stations
- interactive access to large library
- magazines and reading material
- public art

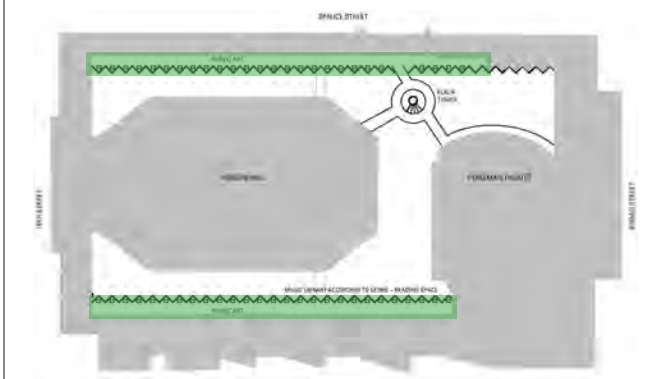

**KIMMEL
CENTER**
CONNECT TO THE ARTS

rooftop garden



rooftop garden
existing

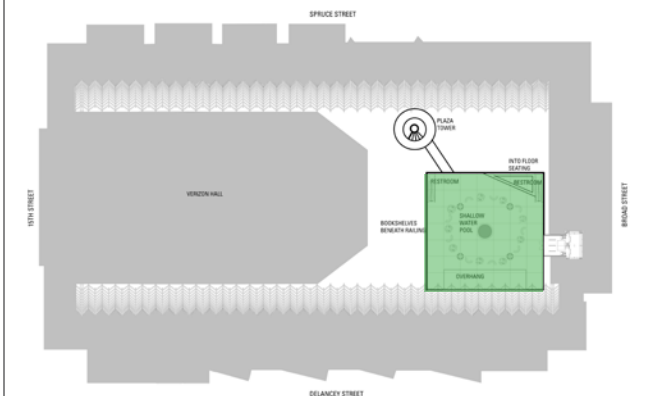

**KIMMEL
CENTER**
CONNECT TO THE ARTS

rooftop garden



rooftop garden *proposed*

key features:

- individual versatile seating
- reading library
- reflection pool
- semi-enclosed lounge area
- recessed floor seating/stage area
- restrooms

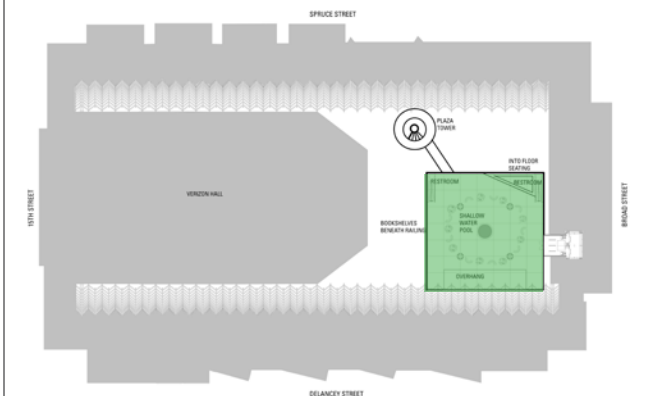

**KIMMEL
CENTER**
CONNECT TO THE ARTS



café on broad

corner of broad and spruce streets
existing

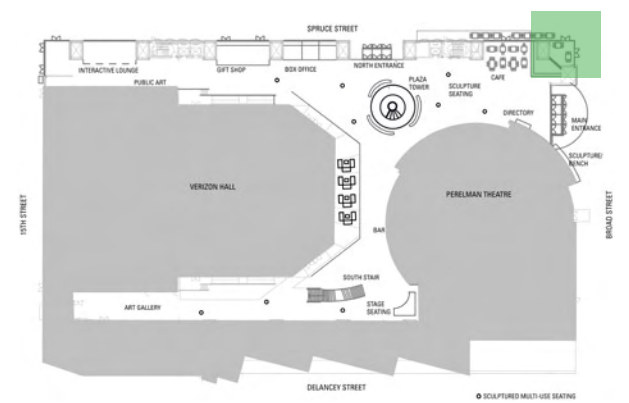

**KIMMEL
CENTER**
CONNECT TO THE ARTS

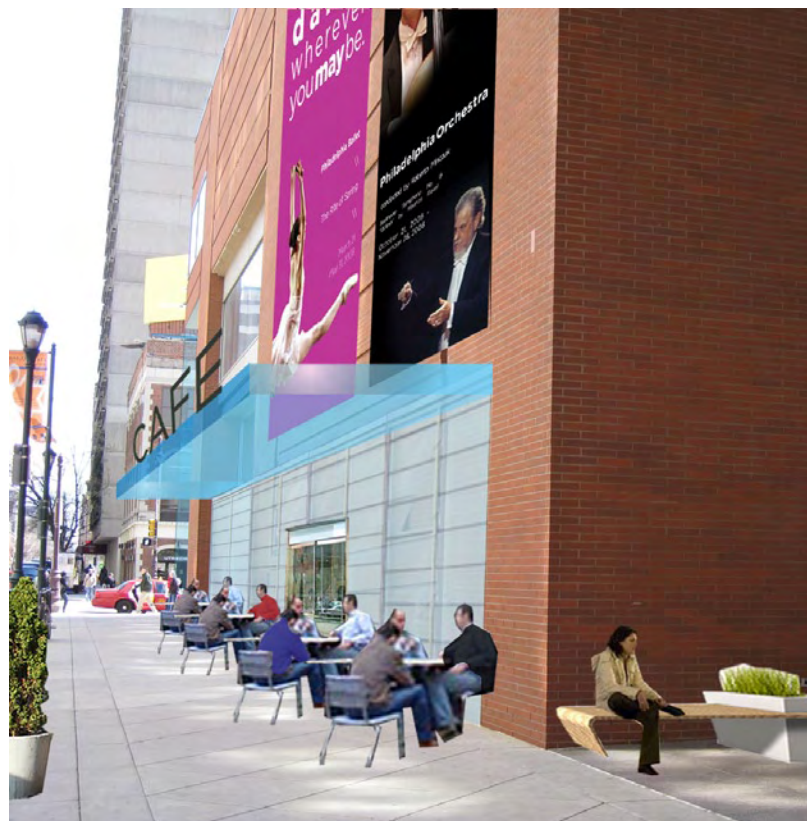

café on broad

corner of broad and spruce streets
proposed

key features:

- glass enclosure
- street-facing cafe
- seasonal outdoor tables
- mobile art
- event signage

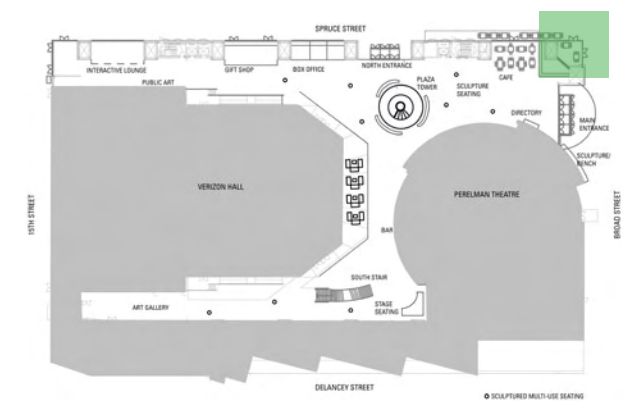

**KIMMEL
CENTER**
CONNECT TO THE ARTS



entrance on 15th

ground floor, view facing 15th street
corner of 15th and spruce streets
existing

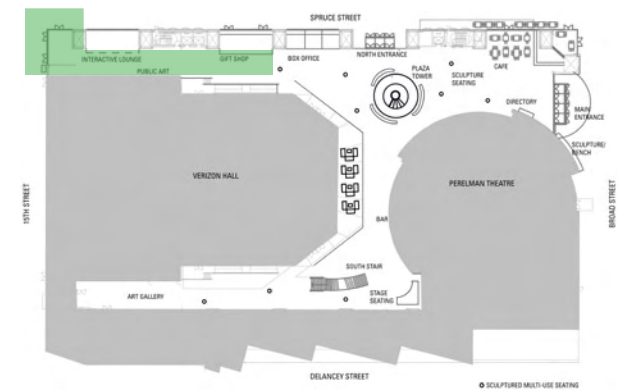

**KIMMEL
CENTER**
CONNECT TO THE ARTS



entrance on 15th

ground floor, view facing 15th street
corner of 15th and spruce streets
proposed

key features:

- new entrance
- open corridor
- glass enclosure
- interactive lounge
- public art

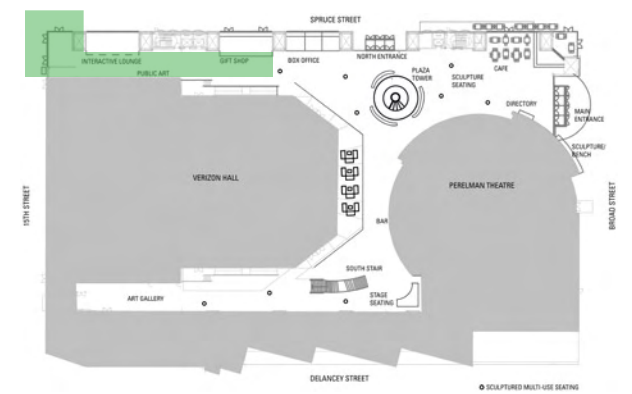

**KIMMEL
CENTER**
CONNECT TO THE ARTS



information display

key features:

- large, colorful event signage
- electronic ink signage
- directional signage indoors
- "today at the kimmel" schedules

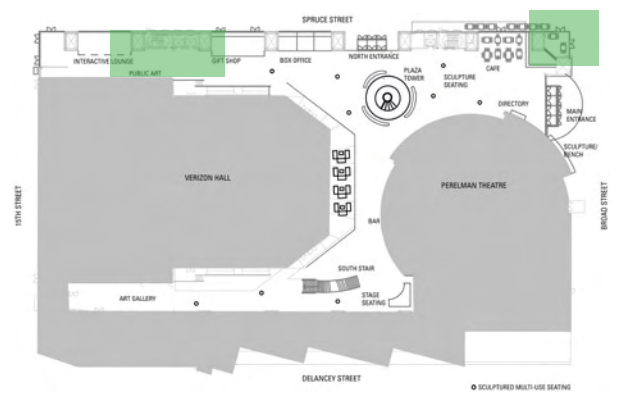

Today
AT THE
KIMMEL
CENTER

7:30
PHILADELPHIA POPS
Verizon Hall

1:15
DANCE CONCERT
Commonwealth Plaza

2:45
GO, GO, GO, JOSEPH!
Perelman Theatre

7:30
PHILADELPHIA POPS
Verizon Hall

**KIMMEL
CENTER**
CONNECT TO THE ARTS



IN CONCLUSION

Our plan suggests dramatic changes to the Kimmel's **public spaces**. We bring a focus on bringing together **community artists** and audiences and a **substantial rethinking** of the indoor layout, with attention to **sustainability** throughout.