

**D R A W N +
Q U A R T E R E D**

Exhibit Guide

LOOK + LISTEN

Visit kierantimberlake.com/exhibit to hear from the architects as they explain the mockups, and to see behind the scenes images of our prototyping process.

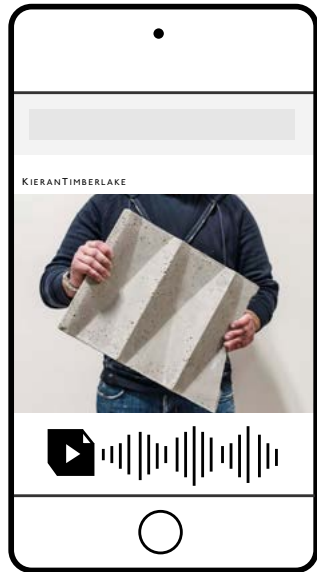

DRAWN + QUARTERED IS ON VIEW IN TWO LOCATIONS

DRAWN

August 1 to October 14, 2016

A selection of works on paper extracted from formative projects that represent a pre-digital approach to planning and design.

Harvey and Irwin Kroiz Gallery

220 South 34th Street at Smith Walk
Philadelphia, PA 19104

Gallery Hours

Monday to Friday: 9:00 AM – 4:00 PM

Saturday and Sunday: Closed

QUARTERED

May 20 to October 14, 2016

A selection of full-scale prototypes, mockups, tests, and trials laid bare in the studio where they were created.

KieranTimberlake

841 North American Street
Philadelphia, PA 19123

Gallery Hours

Monday to Friday: 9:00 AM – 4:00 PM

Saturday and Sunday: Closed

Extended Hours (AIA Convention)

May 20, 1:00 – 6:00 PM

May 21, 10:00 – 4:00 PM

PLAY + DONATE

CANopy

Supporting Philabundance

A sculpture and web app, developed by KieranTimberlake as a pro bono project, raises awareness of the difficulty of eating healthy on a low budget. Using the app generates donations to feed Greater Philadelphians in need.

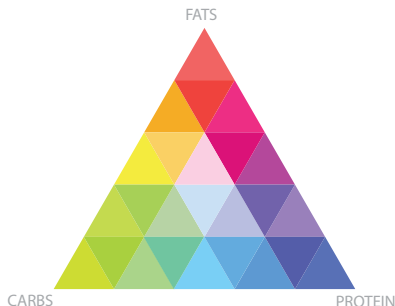

11 KIERANTIMBERLAKE
IDEAL CHOICE HOMES

- 11.1 Lightweight Structural System Concept
- 11.2 Lightweight Concrete Aggregate Tests
- 11.3 Self-Shading Facade Forms

12 RICE UNIVERSITY
NEW OFFICE BUILDING AND PARKING GARAGE

- 12.1 Tensile Fabric Envelope

10 PRIVATE RESIDENCE
LOBLOLLY HOUSE

- 10.1 Reconstructed Critical Detail

13 THE MUSEUM OF MODERN ART
CELLOPHANE HOUSE

- 13.1 SmartWrap™ Facade Panel

9 CITY OF PHILADELPHIA
LOVE PARK

- 9.1 Knife-Edge Roof Fascia

8 US DEPARTMENT OF STATE
EMBASSY OF THE UNITED STATES, LONDON

- 8.1 Outer Envelope Horizontal Chevron
- 8.2 Glass Evaluation Apparatus
- 8.3 Outer Envelope Aluminium Castings
- 8.4 Glass Stair Tread and Bridge
- 8.5 US Embassy Model

7 BROWN UNIVERSITY
SCHOOL OF ENGINEERING

- 7.1 Solar Shading Fin (Wood)
- 7.2 Solar Shading Fin (Foam)
- 7.3 Solar Shading Assembly
- 7.4 On-Site Visual Mockup Fragment
- 7.5 School of Engineering Model

6 KIERANTIMBERLAKE
POINTELIST

- 6.1 Pointelist Prototypes
- 6.2 Pointelist Installation

4 UNIVERSITY OF WASHINGTON
NORTH CAMPUS HOUSING

- 4.1 Building Plinth Brick Bases
- 4.2 Western Red Cedar Panels

5 WELLESLEY COLLEGE
PENDLETON WEST RENOVATION AND ADDITION

- 5.1 Board Form Concrete Studies
- 5.2 Fabric Acoustic Ceiling Panel
- 5.3 Wood Slat Acoustic Wall
- 5.4 Pendleton West Model

2 CENTER CITY DISTRICT
DILWORTH PARK

- 2.1 AESS Specification Pre-Bid Reference
- 2.2 Dilworth Park Model

3 UNIVERSITY OF CALIFORNIA SANTA BARBARA
HENLEY HALL

- 3.1 Hybrid Performance Screen Panel
- 3.2 Henley Hall Model

1 KIERANTIMBERLAKE
PROJECT MAP

- 1.1 Interactive Map

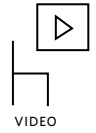

VIDEO

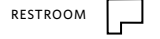

RESTROOM



WELCOME



COFFEE



WORKSHOP